

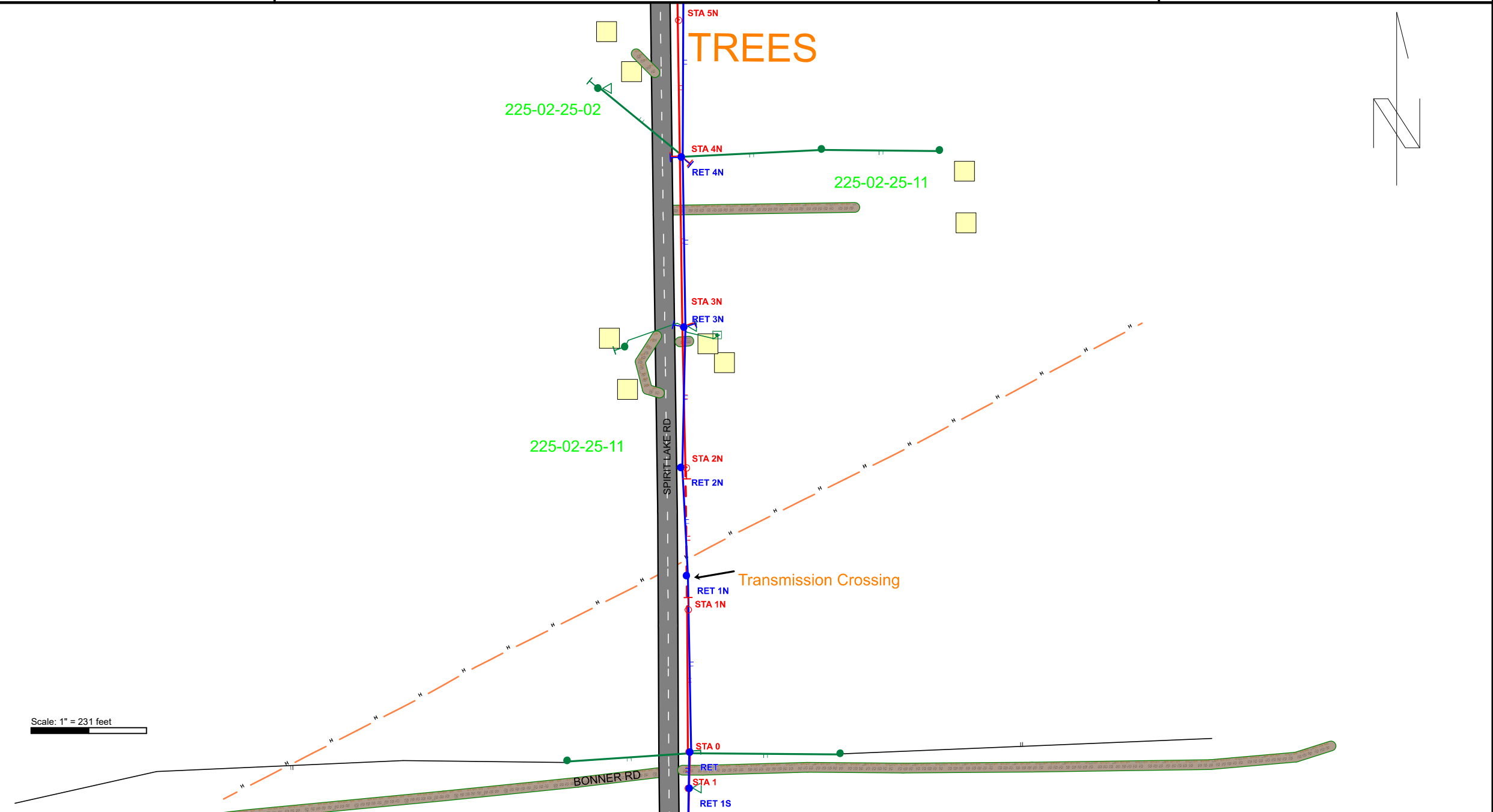

STAKING SHEET

LAKE COUNTRY POWER MINNESOTA 109 SUPERIOR

W.O. Number: **39730**
SO Number: **880431560**
Sheet No.: 13 of 18





STAKING SHEET

LAKE COUNTRY POWER MINNESOTA 109 SUPERIOR

W.O. Number: 39730
SO Number: 880431560
Sheet No.: 14 of 18

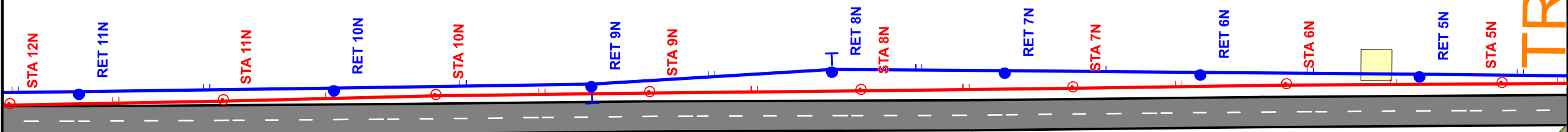
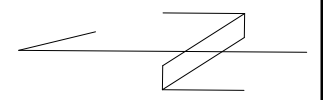

TREES

Scale: 1" = 154 feet

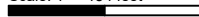



STAKING SHEET

LAKE COUNTRY POWER MINNESOTA 109 SUPERIOR

W.O. Number: **39730**
SO Number: **880431560**
Sheet No.: 15 of 18

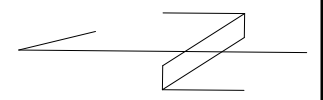

MP LINE

226-00-19-08

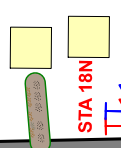

STA 18N

RET 17N

RET 16N
STA 17N

STA 16N

RET 15N

226-00-19-07

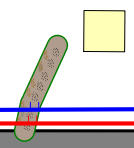

STA 15N

RET 14N

STA 15 STUB

BRUSH

STA 14N
RET 13N

STA 13N
RET 12N

STA 12N

RET 11N

STA 11N

Scale: 1" = 188 feet

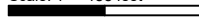



STAKING SHEET

LAKE COUNTRY POWER MINNESOTA 109 SUPERIOR

W.O. Number: **39730**
SO Number: **880431560**
Sheet No.: 16 of 18

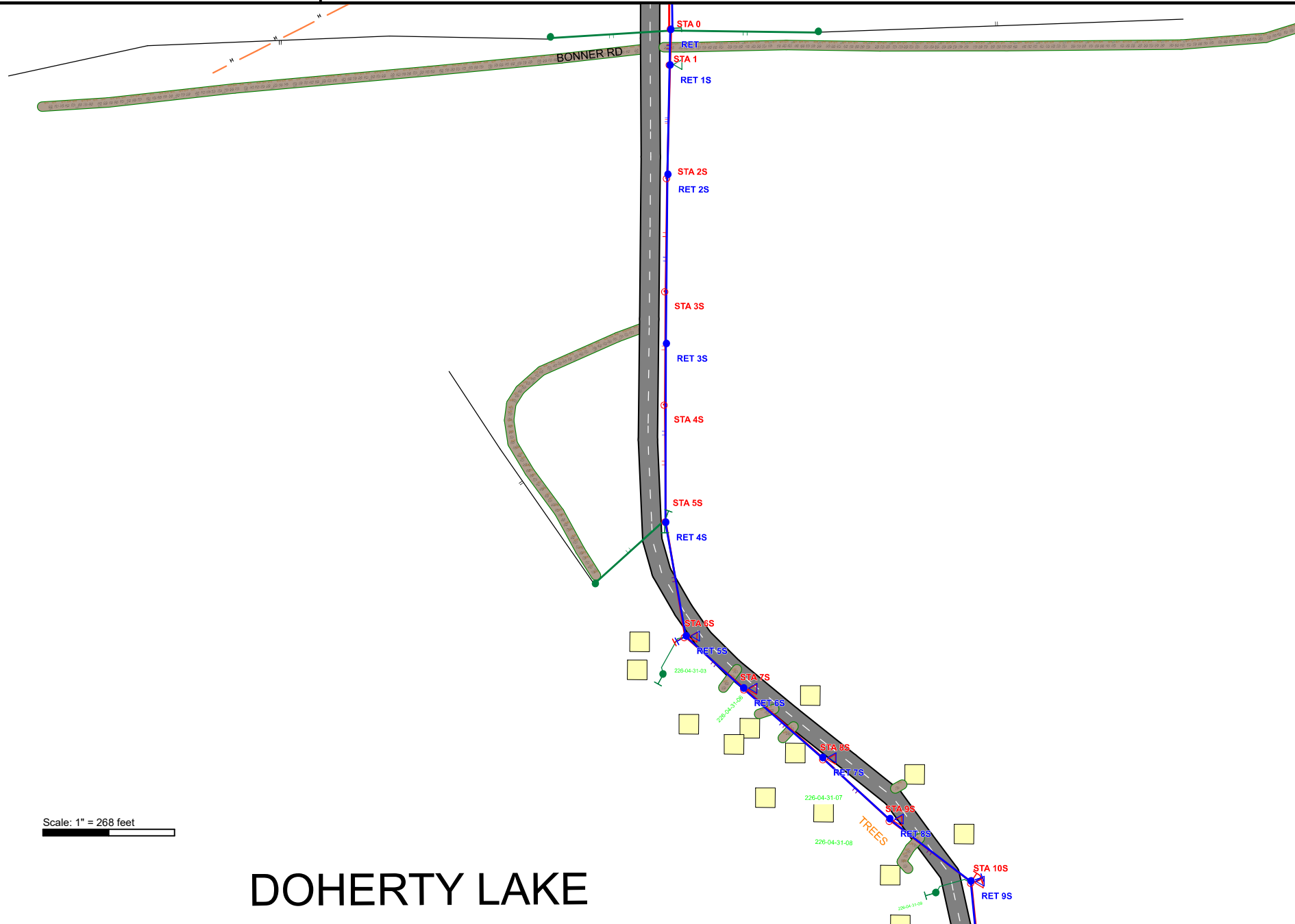

DOHERTY LAKE



STAKING SHEET

LAKE COUNTRY POWER MINNESOTA 109 SUPERIOR

W.O. Number: **39730**
SO Number: **880431560**
Sheet No.: 17 of 18

DOHERTY LAKE

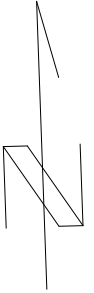

Scale: 1" = 324 feet

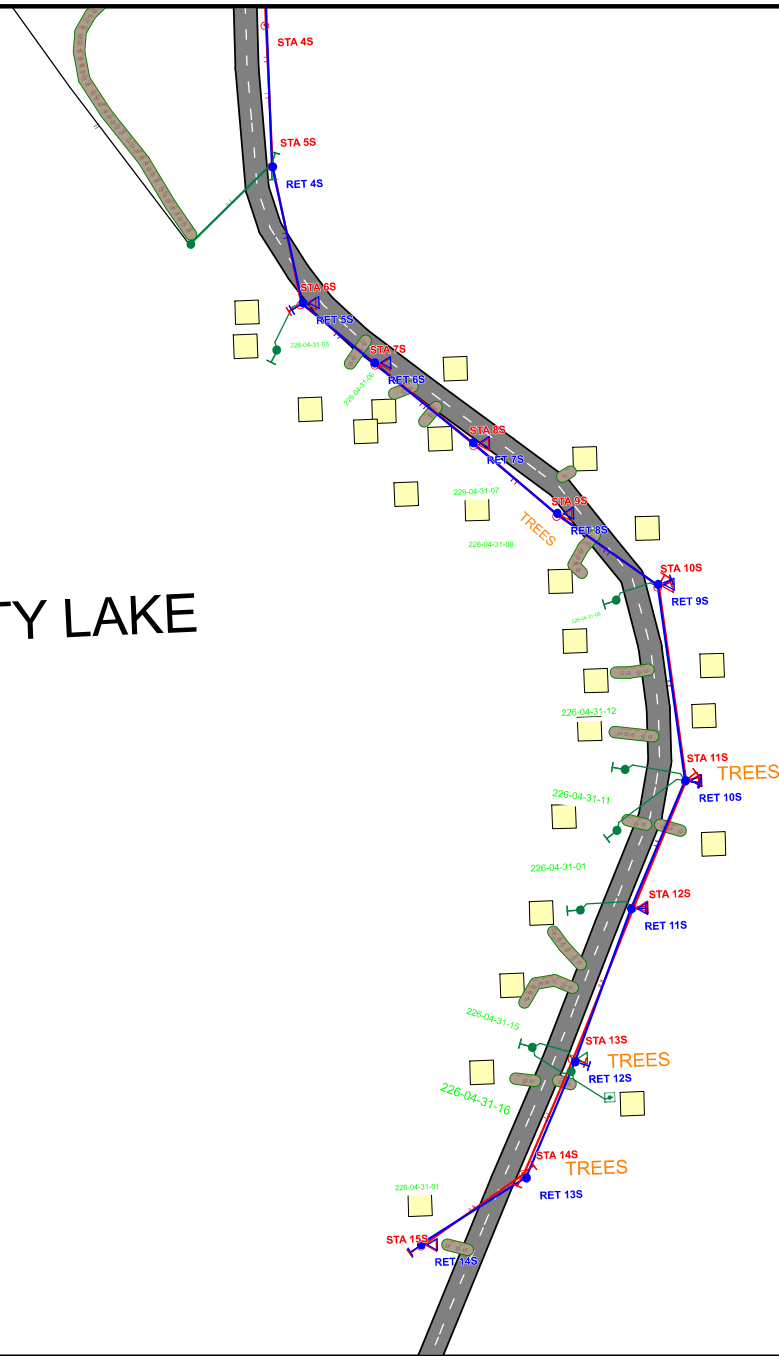



STAKING SHEET

LAKE COUNTRY POWER MINNESOTA 109 SUPERIOR

W.O. Number: 39730
SO Number: 880431560
Sheet No.: 18 of 18

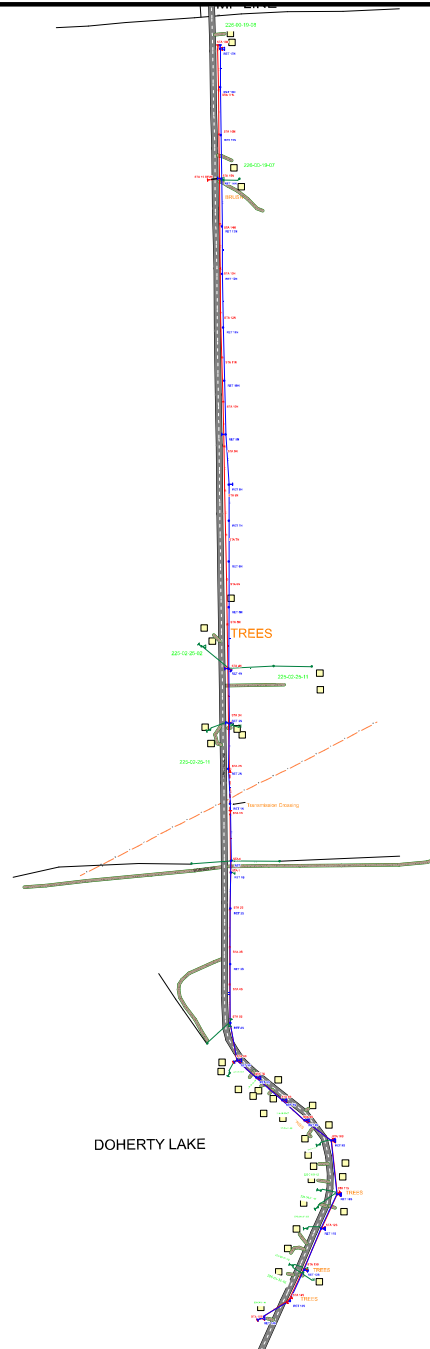

Scale: 1" = 1189 feet

